



AIRPORT BUMP RAILS



Airport Bump Rail

Kent Stainless Airport Bump Rails are usually chosen for the sleek architectural appearance of the flat bar upright supports. Flat Bar supports are 1/3" or 8mm – but increased in thickness on request for higher loadings.

It can be used also as a Cane Detection Rail for the visually impaired.

This style of Tubular Bump Rail is typically supplied mounted on a circular base plate with countersunk fixings. The base plates are surface mounted as standard or bolted to the subsurface below the tiled floor as an option.

Small to Medium sized projects in the USA & Canada will ship from East Coast USA. Major international projects will ship from Ireland.

American projects are mostly made in the USA and made to imperial measures – typically a 2" dia tube and 11" high. This same bump rail supplied to European projects would be supplied as a metric measure 48.3mm dia and 280mm high – rather than an exact conversion of 2" to 50.8mm and 11" to 279.4mm. Approval drawings for each project will be supplied in imperial or in metric as requested and can be customised.

- FEATURES**
- 12GA (2.5mm) thick steel
 - 0GA (0.3in/8mm) thick supports
 - ASTM No. 6 Satin Finish (USA)
 - EN10088 320 Grit Satin Finish (EU)
 - Circular Baseplates as standard for airports, rail stations etc
 - Base plate can be secured above or beneath floor tile
 - Grade 304L Stainless Steel as standard
 - 316L as an option

- INDUSTRIES**
- Airports
 - Railway Stations
 - Stadia
 - Bus Terminals

Flush Weld End Cap Straight or turned in 2" O.D.

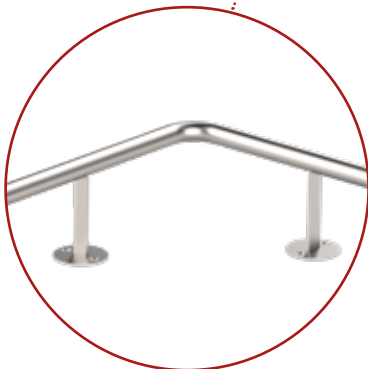

Internal & External Corners



39" / 79" / 118" Lengths



Hidden Sleeve Joint welded to tube allows for push-fit assembly on-site

Product Code	Length	Height	Diameter	
			USA	EU
Kent Airport Bump Rail KABR-50	39.37" (1000mm)	11" (280mm)	2"	48.3mm
Kent Airport Bump Rail KABR-50	78.74" (2000mm)	11" (280mm)	2"	48.3mm
Kent Airport Bump Rail KABR-50	117.72" (2990mm)	11" (280mm)	2"	48.3mm

DRAWINGS

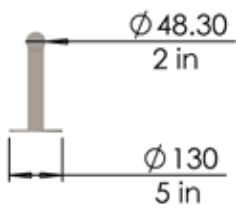
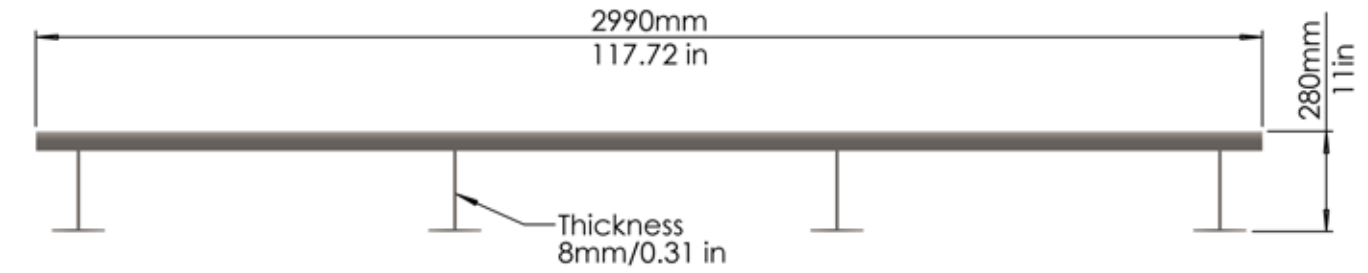

Optimal shipping length is 117.72" or 9.76' (2990mm)
- custom lengths are regularly provided



Corner Section

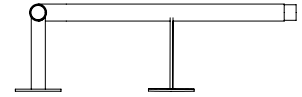
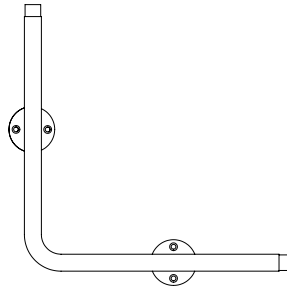

Append (CS) Kent Airport Bump Rail KABR 50 (CS) 90deg.
State Angle From 45deg. to 135deg.

Circle Column

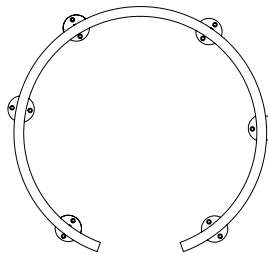

Append (CC) Kent Airport Bump Rail KABR 50 (CC) 78.74" (2,000mm).
State Diameter 39.37" (1,000mm) to 78.74" (2,000mm).

Square Column

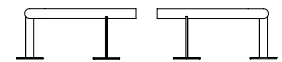
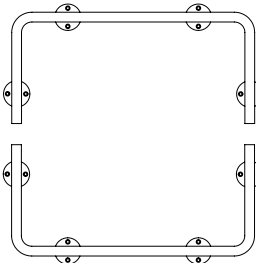

Append (SC) Kent Airport Bump Rail KABR 50 (SC) 39.37" (1,000mm) x 39.37" (1000mm).
State Length & Width 19.68" (500mm) to 39.37" (1,000mm).

U-Bend Section

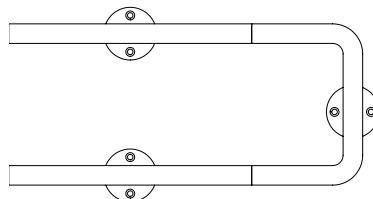

Append (UB) Kent Airport Bump Rail KABR 50 (UB) 9.84" (250mm).
State Width 9.84" (250mm) to 19.68" (500mm).

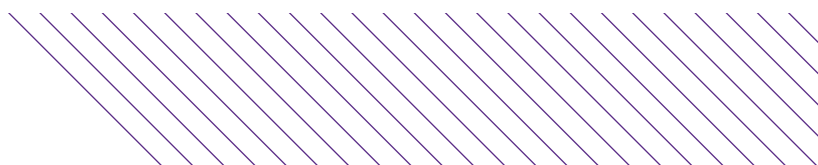

SPECIFY

Kent Airport Bump Rail (KABR-50): ▶ Grade 304L Stainless Steel; ▶ ASTM No. 6 Polish (EN10088 320 Grit Satin Finish); ▶ L: 117.72" (2990mm), H: 11" (280mm), Dia: 2" (48.3mm); ▶ 12GA (2.5mm Thick Steel); ▶ Visible Base Plate with Countersunk Fixings.



